

F30-2



FLAT SUCTION CUP WITH CLEATS

- ▶ Suitable for flat objects.
- ▶ Good stability and little inherent movement.
- ▶ Recommended when the lifting force is parallel to the surface of the object.
- ▶ Cleats prevent thin, sensitive objects from being deformed and gives extra friction when the lifting force is parallel.

LIFTING FORCES & TECHNICAL DATA

| Lifting force vertical to the surface, N, at vacuum level | | | Lifting force parallel to the surface, N, at vacuum level | | | Volume | Min. curve radius | Max. vertical movement | Weight rubber part |
|---|---------|---------|---|---------|---------|-----------------|-------------------|------------------------|--------------------|
| 20 -kPa | 60 -kPa | 90 -kPa | 20 -kPa | 60 -kPa | 90 -kPa | cm ³ | mm | mm | g |
| 12.0 | 25 | 31 | 11.0 | 16.0 | 20.0 | 2.0 | 25 | 2.0 | 2.2 |

MATERIAL SPECIFICATIONS

| Material | Colour | Hardness °Shore A | Temperature range °C |
|-----------------|--------|-------------------|----------------------|
| Chloroprene, CR | Black | 50 | -40-110 |
| Silicone, SIL | Red | 50 | -40-200 |

MATERIAL RESISTANCE

| Material | Wear resistance | Oil | Weather & ozone | Hydrolysis | Petrol | Concentrated acids | Alcohol | Oxidation |
|-----------------|-----------------|------|-----------------|------------|--------|--------------------|---------|-----------|
| Chloroprene, CR | Excellent | Fair | Good | Good | Fair | Poor | Good | Good |
| Silicone, SIL | Good | Poor | Excellent | Fair | Poor | Poor | Good | Excellent |

ORDERING INFORMATION

| | Complete suction cups | Art. No. |
|---|---|----------|
| A | Suction cup F30-2 Chloroprene, M5 female | 0101325 |
| A | Suction cup F30-2 Chloroprene, M5 female, with dual flow control valve | 0101331 |
| B | Suction cup F30-2 Chloroprene, G1/8" male, with mesh filter | 0101326 |
| B | Suction cup F30-2 Chloroprene, G1/8" male, with mesh filter and dual flow control valve | 0101332 |
| C | Suction cup F30-2 Chloroprene, G1/8" male/M5 female, with mesh filter | 0101330 |
| C | Suction cup F30-2 Chloroprene, G1/8" male/M5 female, with dual flow control valve | 0101334 |
| E | Suction cup F30-2 Chloroprene, G1/8" male/M5 female PA | 0109846 |
| F | Suction cup F30-2 Chloroprene, G1/8" male/M5 female, with cone valve | 3250039 |
| D | Suction cup F30-2 Chloroprene, 5xM5 female | 0101329 |
| A | Suction cup F30-2 Silicone, M5 female | 0101341 |
| B | Suction cup F30-2 Silicone, G1/8" male, with mesh filter | 0101342 |
| B | Suction cup F30-2 Silicone, G1/8" male, with mesh filter and dual flow control valve | 0101348 |
| C | Suction cup F30-2 Silicone, G1/8" male/M5 female, with mesh filter | 0101346 |
| C | Suction cup F30-2 Silicone, G1/8" male/M5 female, with dual flow control valve | 0101350 |
| D | Suction cup F30-2 Silicone, 5xM5 female | 0101345 |
| E | Suction cup F30-2 Silicone, G1/8" male/M5 female PA | 0110344 |
| F | Suction cup F30-2 Silicone, G1/8" male/M5 female, with cone valve | 3250039S |

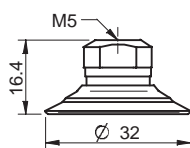

A

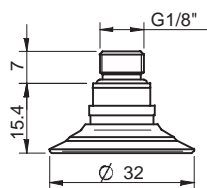

B

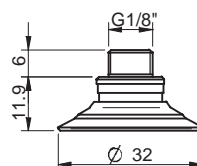

C

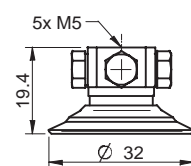

D

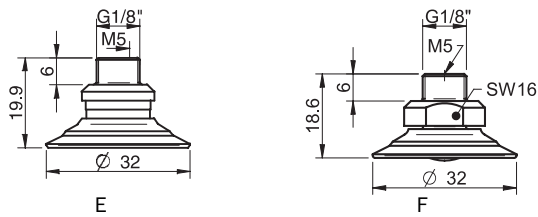

| Rubber parts | Art. No. |
|--|----------|
| Suction cup F30-2 Chloroprene | 0101133 |
| Suction cup F30-2 Chloroprene, for fitting with cone valve | 3150239 |
| Suction cup F30-2 Silicone | 0101134 |
| Suction cup F30-2 Silicone, for fitting with cone valve | 3150239S |

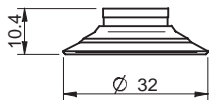

| Fittings | Art. No. |
|--|----------|
| Fitting M5 female | 3250003 |
| Fitting M5 female, with dual flow control valve | 3251001 |
| Fitting G1/8" male, with mesh filter | 3250085 |
| Fitting G1/8" male, with mesh filter and dual flow control valve | 3251002 |
| Fitting G1/8" male/M5 female, with mesh filter | 0101152 |
| Fitting G1/8" male/M5 female, with dual flow control valve | 3251004 |
| Fitting G1/8" male/M5 female, with cone valve | 0101155 |
| Fitting 5xM5 female | 0100260 |
| Fitting 5xM5 female, with dual flow control valve | 3251005 |
| Fitting G1/8" male/M5 female, PA | 3150196 |

For further information and dimensioned drawings, see *SUCTION CUPS FITTINGS* chapter.

| Spare Part | Material | Temperature range °C | Art. No. |
|----------------------|-----------|-------------------------|----------|
| Cone valve for F30-2 | Al/SS/NBR | -40-110 | 3150055 |